

# METRIC 2402 SF SERIES FLOATING INSERT, SNAP-IN HEAD STYLE

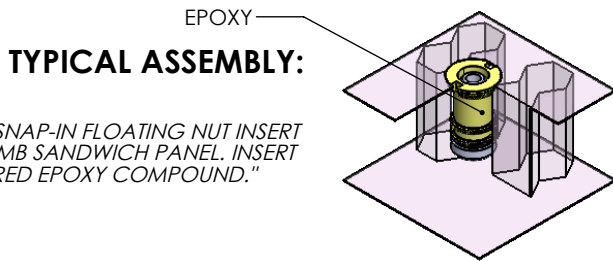
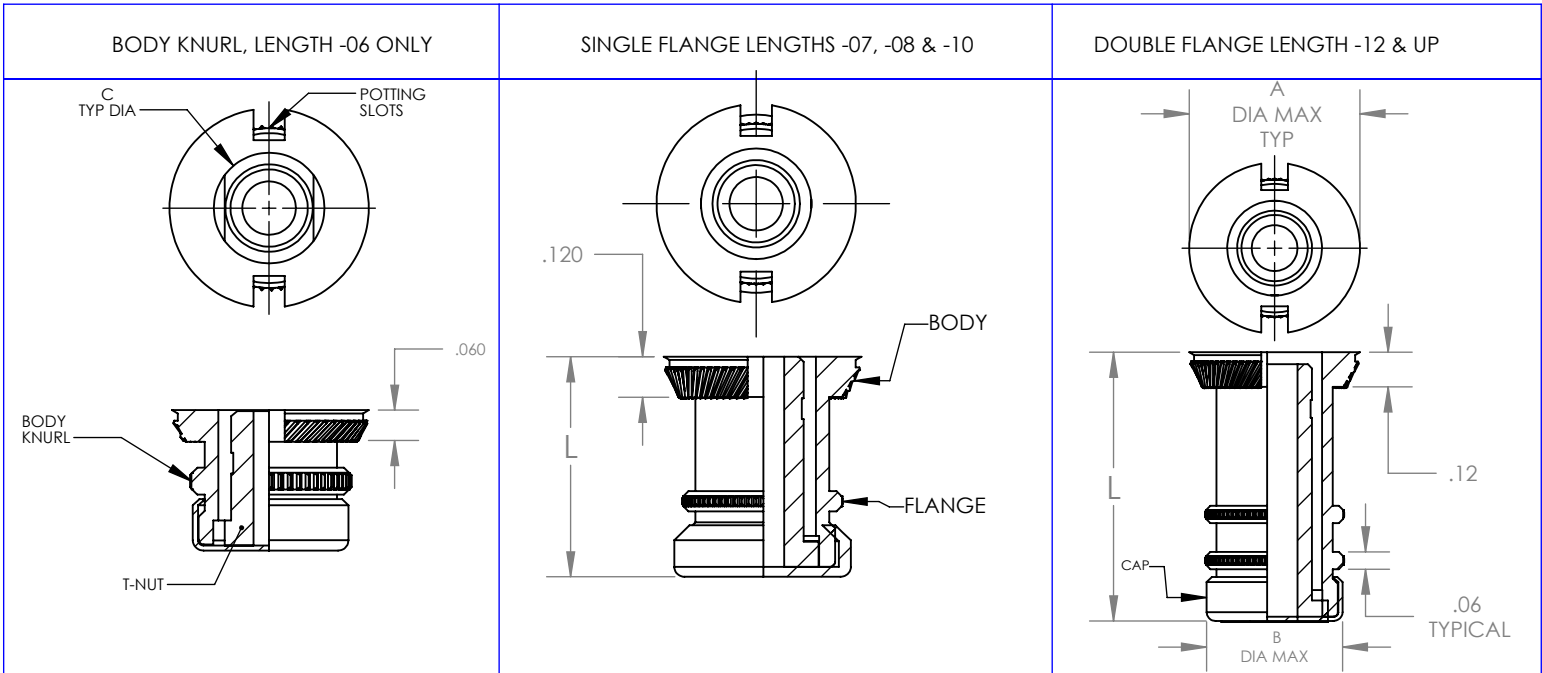

" TYPICAL SERIES 2402SF SNAP-IN FLOATING NUT INSERT INSTALLED IN HONEYCOMB SANDWICH PANEL. INSERT IS HELD IN PLACE BY CURED EPOXY COMPOUND."

**PART NUMBER EXAMPLE:**

2402SF6-M5-08 2

- ADD "NS" IF POTTING SLOTS ARE NOT REQUIRED
- SKIN THICKNESS, TABLE II
- LENGTH, TABLE III
- ADD "M" FOR SOLIDFILM LUBE ON THREADS
- THREAD SIZE, TABLE I
- THREAD TYPE: N = THREADED ONLY  
- = CRIMP LOCK PER MIL-N-25027
- MATERIAL FOR NUT
- "6"=303 STAINLESS STEEL PER ASTM-A-582, PASSIVATE PER ASTM-A-967
- "9"=1215 CARBON STEEL PER ASTM-A-108, CAD PLATE PER SAE-AMS-QQ-P-416 TYPE 2, CLASS 2.
- FLUSH HEAD STYLE, SNAP-IN, FLOATING NUT, POTTING SERIES
- SERIES DESIGNATION

NOTE: 1. MINIMUM RADIAL FLOAT IS .031"

2. TOLERANCES: XXX = +/- .010

3. MATERIAL FOR BODY IS 2024 T351 OR T4 ALUMINUM PER QQ-A-225/6 WITH CHEM FILM PER MIL-DTL-5541F CLASS 1A.

4. MATERIAL FOR CAP IS 2024 T351 OR T4 OR 6061 T6511 ALUMINUM WITH CHEM FILM PER MIL-DTL-5541F CLASS 1A.

WITTEN COMPANY  
918-272-9567

APPROVAL DATE: 3/29/2022

CAGE CODE: 0JHK5